



Quadri in poliestere
Polyester boxes



0800



Istruzioni montaggio piastre scorrevoli - *Moveable base-plate mounting instruction*

Componenti, tipo e numero presenti nella confezione - *Components (type and number) present in the package*

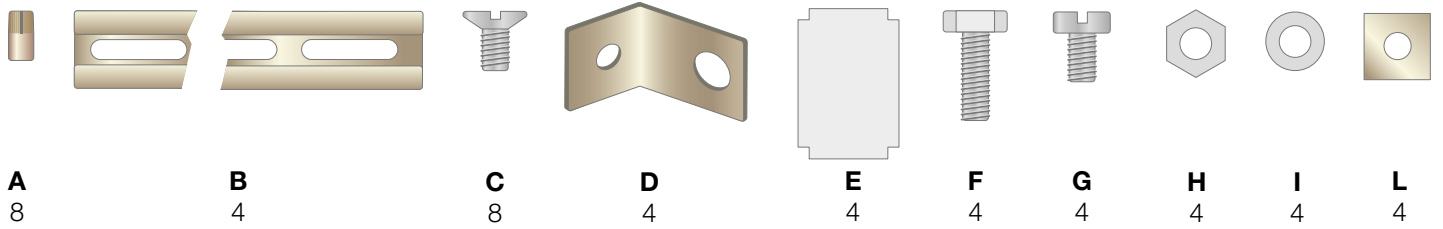

A 8 **B** 4 **C** 8 **D** 4 **E** 4 **F** 4 **G** 4 **H** 4 **I** 4 **L** 4

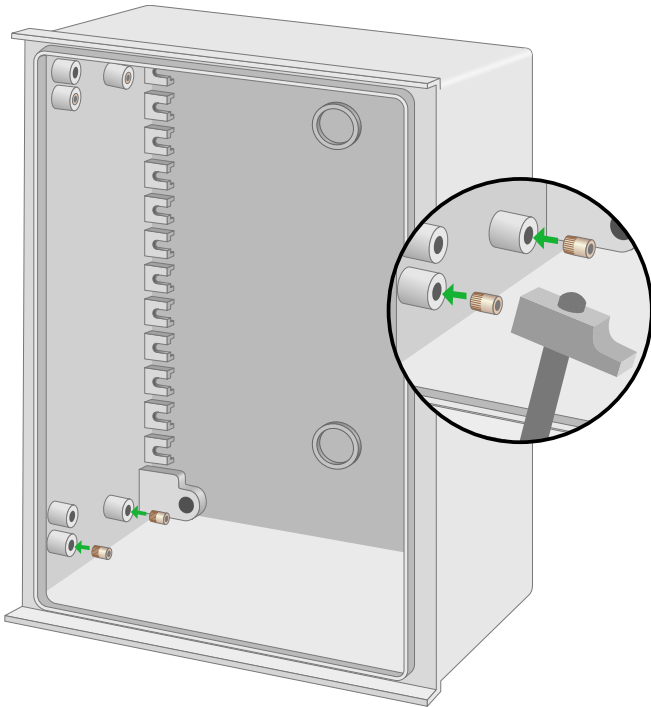

Inserire gli inserti metallici (A) nelle apposite sedi laterali
Put in the metal insert (A) in the proper side seat

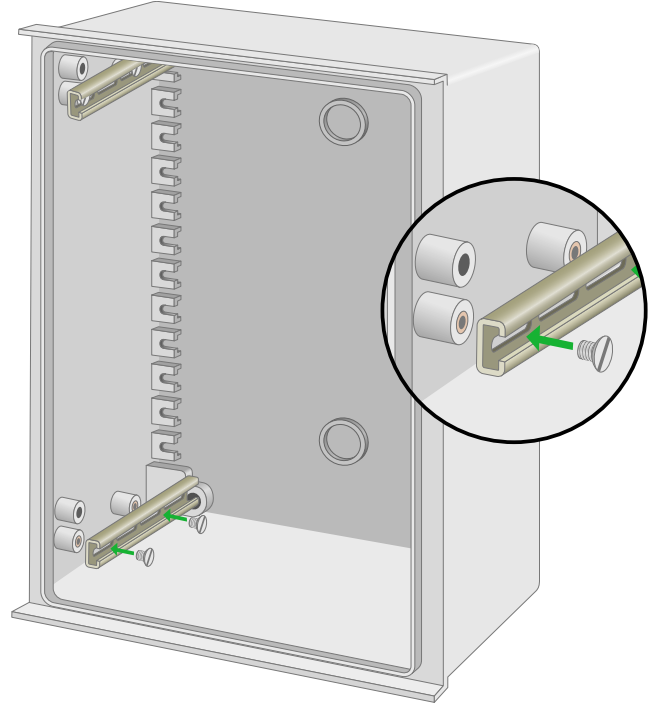

Applicare le guide (B) con le viti (C) negli inserti metallici
Put on guides (B) with screws (C) in the metal insert

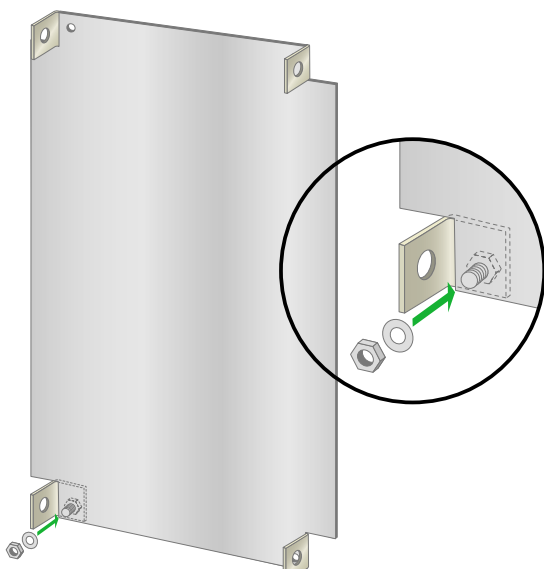

Applicare le staffe (D) alla piastra di fondo (E) utilizzando i bulloni (F), le rondelle (G) e i dadi (H)
Put on bracket (D) on base plate (E) using bolts (F) rings (G) and nuts (H)

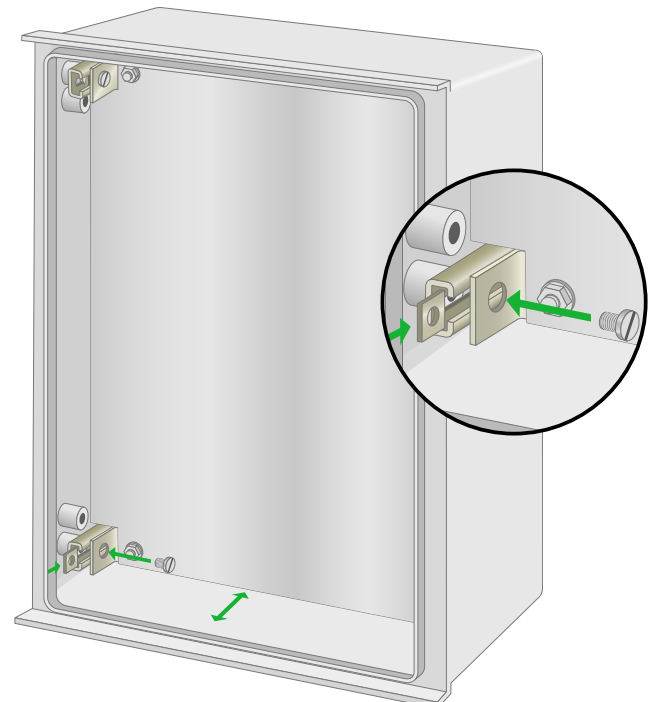

Inserire la piastra con le staffe montate e regolarle sulle guide con le viti (I) e i dadi quadrati (L)
put in the plate with mounted brackets and adjust it on the guides with the screws (I) and the square nuts (L)

040/080

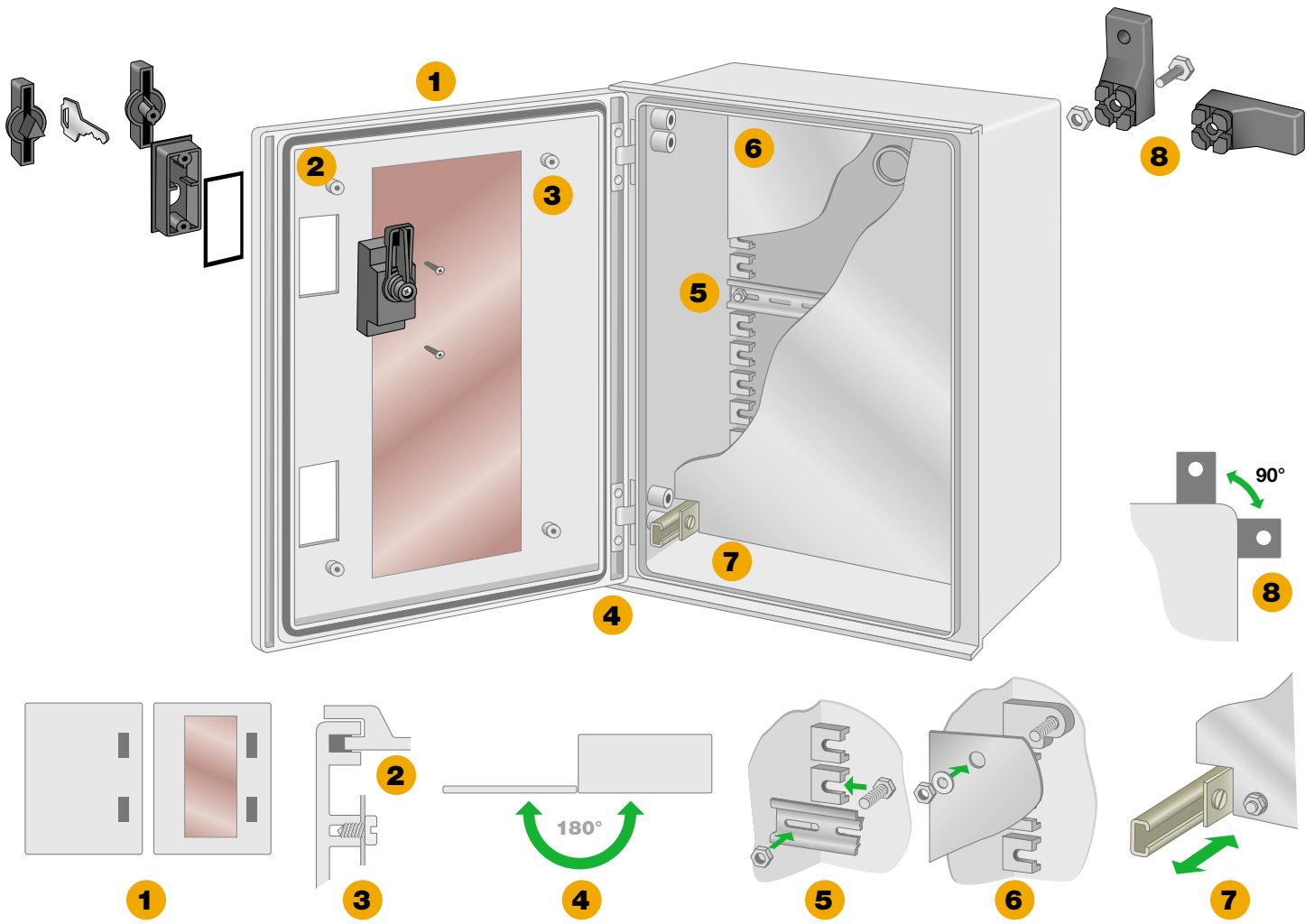

Caratteristiche Tecniche - Technical data

MATERIALE QUADRO
HOUSING MATERIAL

Poliestere con fibre di vetro - grigio RAL 7035 - Polyester reinforced with fiber glass - grey RAL 7035

MATERIALE CHIUSURE
LOCKS MATERIAL

Poliammide con fibre di vetro - nero RAL 9005 - Polyamide reinforced with fiber glass - black RAL 9005

MATERIALE CERNIERE
HINGES MATERIAL

Fusione in lega di alluminio - Aluminium alloy casting

RESISTENZA ALLA FIAMMA
FIRE STRENGTH

Autoestinguente V0 - Self-extinguishing V0

GRADO DI PROTEZIONE
PROTECTION RATING

IP65 CEI EN 60529

PROTEZIONE AGLI AGENTI
ATMOSFERICI
ATMOSPHERICAL AGENTS
PROTECTION

Basso assorbimento acqua. Resistente agli agenti chimici e corrosivi
Minimum water absorption. Resistant to chemical and corrosion agents

LIMITI DI TEMPERATURA
TEMPERATURE LIMITS

-30° C ÷ +120° C

PROTEZIONE CONTRO GLI IMPATTI
PROTECTION AGAINST IMPACT

IK 09 EN 50102



Quadri in poliestere / Polyester boxes **250 x 300 mm**



gr.	↕	Porta Completa / Standard door
		080Q2530-16
3.600	160	



gr.	↕	Porta con finestra / Transparent door
		080Q2530-16F
3.500	160	



Accessori adattabili
Adaptable accessories

Chiusura inserto ad aletta Double bar lock	080 CA
Chiusura inserto triangolo Triangular lock	080 CT
Chiusura inserto a chiave Key lock	080 CC
Staffe fissaggio esterno Wall fixing bracket	080 SE
Piastra di fondo plastica Plastic base-plate	080 PP2530
Piastra di fondo metallo Metallic base-plate	080 PM2530

040/080

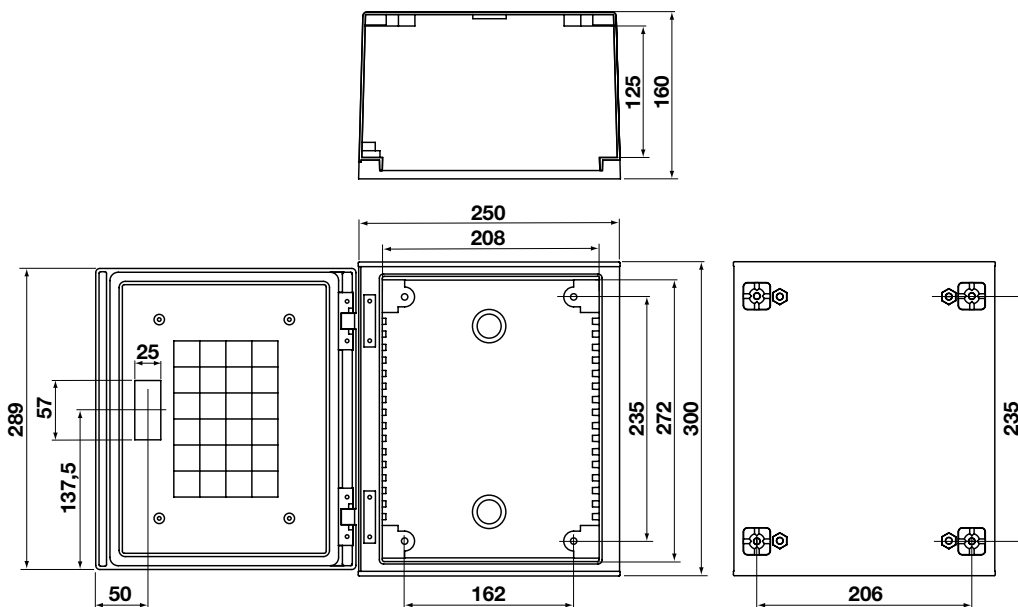



Quadri in poliestere / Polyester boxes **300 x 400 mm**



		Porta Completa / Standard door
4.900	200	080Q3040-20



		Porta Con Finestra / Transparent door
4.700	200	080Q3040-20F



Accessori adattabili
Adaptable accessories

Chiusura inserto ad aletta <i>Double bar lock</i>	080 CA
Chiusura inserto triangolo <i>Triangular lock</i>	080 CT
Chiusura inserto a chiave <i>Key lock</i>	080 CC
Staffe fissaggio esterno <i>Wall fixing bracket</i>	080 SE
Piastra di fondo plastica <i>Plastic base-plate</i>	080 PP3040
Piastra di fondo metallo <i>Metallic base-plate</i>	080 PM3040
Guida regolazione 200 <i>Adjusting guide</i>	080 GR200

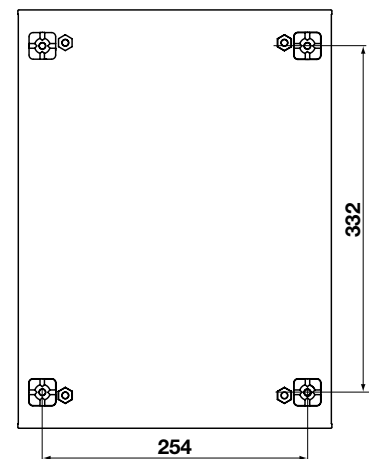
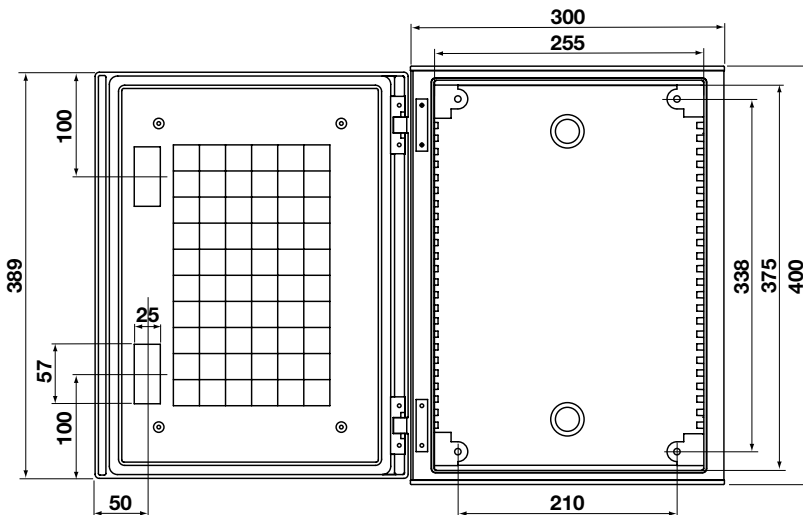
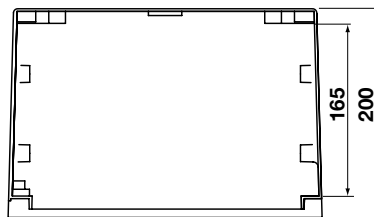



Quadri in poliestere / Polyester boxes **400 x 500 mm**



gr.	↕	Porta Completa / Standard door
		6.300 200 080Q4050-20



gr.	↕	Porta Con Finestra / Transparent door
		6.100 200 080Q4050-20F



Accessori adattabili
Adaptable accessories

Chiusura inserto ad aletta Double bar lock	080 CA
Chiusura inserto triangolo Triangular lock	080 CT
Chiusura inserto a chiave Key lock	080 CC
Staffe fissaggio esterno Wall fixing bracket	080 SE
Piastra di fondo plastica Plastic base-plate	080 PP4050
Piastra di fondo metallo Metallic base-plate	080 PM4050
Guida regolazione 200 Adjusting guide	080 GR200

040/080

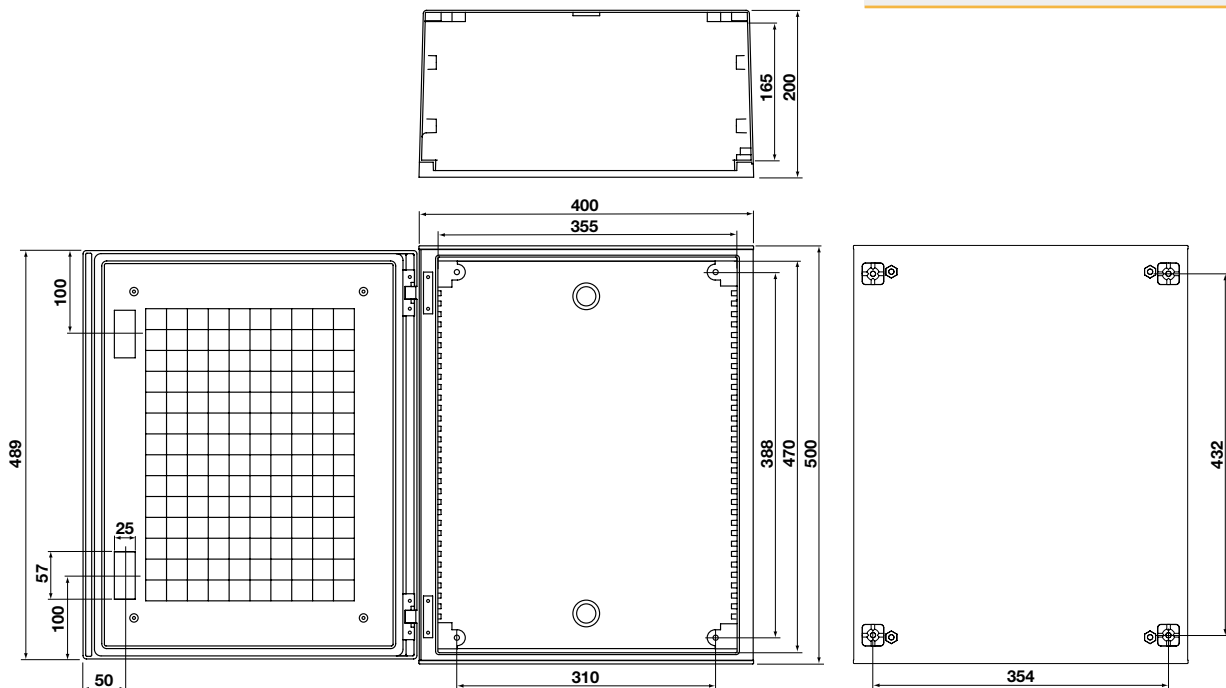



Quadri in poliestere / Polyester boxes **500 x 600 mm**



		Porta Completa / <i>Standard door</i>
7.900	250	080Q5060-25



		Porta Con Finestra / <i>Transparent door</i>
7.700	250	080Q5060-25F



Accessori adattabili
Adaptable accessories

Chiusura inserto ad aletta <i>Double bar lock</i>	080 CA
Chiusura inserto triangolo <i>Triangular lock</i>	080 CT
Chiusura inserto a chiave <i>Key lock</i>	080 CC
Staffe fissaggio esterno <i>Wall fixing bracket</i>	080 SE
Piastra di fondo plastica <i>Plastic base-plate</i>	080 PP5060
Piastra di fondo metallo <i>Metallic base-plate</i>	080 PM5060
Guida regolazione 250 <i>Adjusting guide</i>	080 GR250

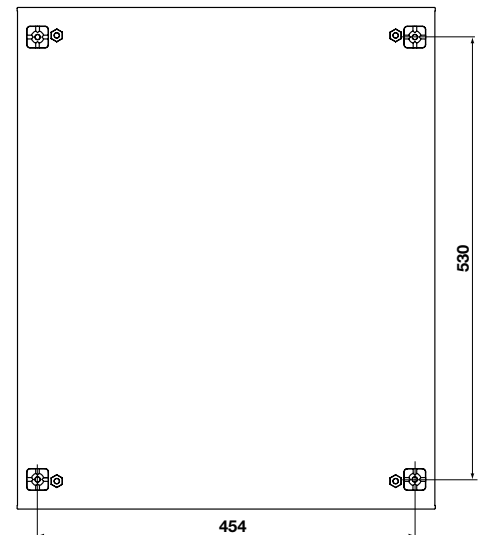
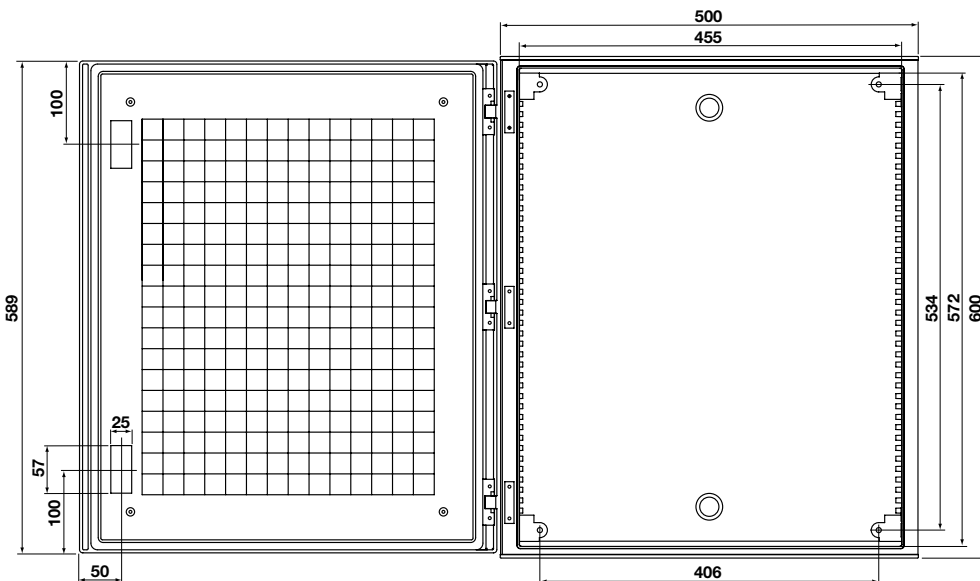
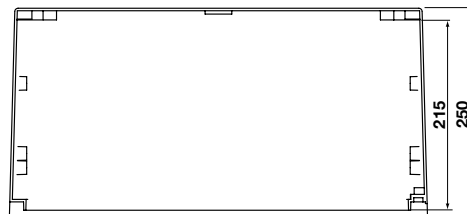



	Chiusura aletta / <i>Double bar lock</i>
70	080CA



	Chiusura chiave / <i>Key lock</i>
140	080CC



	Staffe fissaggio esterno / <i>Wall fixing brackets</i>
110	080SE



	Piastra di fondo plastica / <i>Plastic base-plate</i>
1.800	080PP2530
2.700	080PP3040
3.600	080PP4050
4.700	080PP5060



	Piastra di fondo metallo / <i>Metallic base-plate</i>
2.100	080PM2530
3.200	080PM3040
4.300	080PM4050
5.300	080PM5060

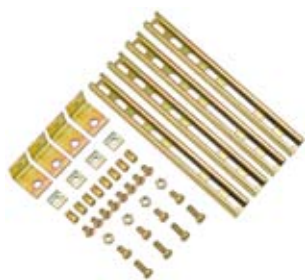

	Guide regolazione / <i>Adjusting guide</i>
380	080GR200
450	080GR250



760	Guida / Rail Ω 35 PVC	010GDP
-----	------------------------------	--------

L = 2000

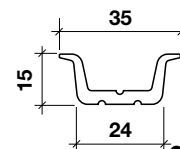



Pressacavi

PASSACAVI
CABLE CLAMPS⁽¹⁾



P		F	A	B	C	L	CODICE
PG7	4	12,5	3-6,5	15	8	18-22	010NPG7
PG9	6	15,5	4-8	19	8	22-26	010NPG9
PG11	9	19	5-10	22	8	23-28	010NPG11
PG13,5	11	20,5	6-12	24	10	24-29	010NPG13
PG16	13	22,5	9-14	27	10,5	26-31	010NPG16
PG21	21	29	13-18	33	12	30-35	010NPG21
M12 x 1,5	4	12,5	3-6,5	15	8	21	010NM12
M16 x 1,5	7	16,5	5-10	22	8	23-28	010NM16
M20 x 1,5	11	20,5	6-12	24	10	24-29	010NM20
M25 x 1,5	16	25,5	13-18	33	12	30-35	010NM25
M32 x 1,5	23	32,5	18-25	42	11	34-40	010NM32

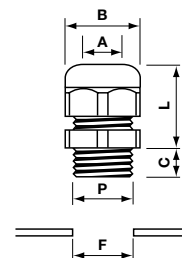

SPIRALI / SPIRALS⁽¹⁾



P		F	A	B	C	L	CODICE
PG11	16	19	5-10	22	8	80	010FPG11
PG13,5	19	20,5	6-12	24	10	90	010FPG13
PG16	25	22,5	9-14	27	10,5	100	010FPG16
PG21	25	29	13-18	33	11	111	010FPG21
M12 x 1,5	7	126,5	3-6,5	15	8	54	010FM12
M16 x 1,5	10	16,5	5-10	22	8	80	010FM16
M20 x 1,5	19	20,5	6-12	24	10	90	010FM20
M25 x 1,5	33	25,5	13-18	33	12	112	010FM25

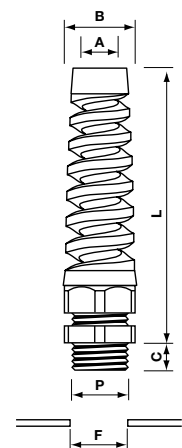

CONTRODADO
LOCK NUT⁽¹⁾



P		B	H	CODICE
PG7	1	19	5	010DPG7
PG9	2	22	5	010DPG9
PG11	2	24	5	010DPG11
PG13,5	2,5	27	6	010DPG13
PG16	3	30	6	010DPG16
PG21	3,5	36	7	010DPG21
M12 x 1,5	1	18	5	010DM12
M16 x 1,5	1,5	24	6	010DM16
M20 x 1,5	2	27	6	010DM20
M25 x 1,5	3	34	7	010DM25
M32 x 1,5	5	41	7	010DM32

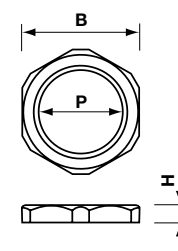

TAPPI / PLUGS⁽²⁾



P		ø A	H	CODICE
PG7	1	15	6	010TPG7
PG9	1,5	19	6	010TPG9
PG11	2	22	7	010TPG11
PG13,5	2	25	7	010TPG13
PG16	3	27	7	010TPG16
PG21	5	33	9	010TPG21
M12 x 1,5	1	15	6	010TM12
M16 x 1,5	2	22	6	010TM16
M20 x 1,5	2,4	24	7	010TM20
M25 x 1,5	4	33	9	010TM25
M32 x 1,5	42	38	11	010TM32

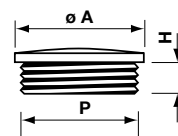

(1) Poliammide PA6 autoestinguente cl. V2 (UL94) - Temperatura d'impiego -20° ÷ +90° / V2 (UL94) self-extinguishinPA polyammide operating temperature -20° ÷ +90°
 (2) Polistirolo PS - Temperatura d'impiego -20° ÷ +60° / PS Polystyrene - operating temperature -20° ÷ +60°



Raccordi metallici / Metal connectors⁽¹⁾

Raccordo curvo a 45° - Connector bent to 45°



gr.	D	XOK		L	
26	M16x1,5	11,5	19	10	010GIM16
38	M20x1,5	15	23	10	010GIM20
55	M25x1,5	20	28	10	010GIM25
90	M32x1,5	27	36	10	010GIM32

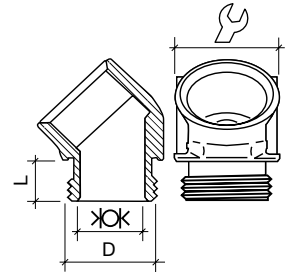

Pressacavi / Glands



gr.	D	XOK		LF	
14	M16x1,5	5 ÷ 9	18	17	010POM16
20	M20x1,5	8 ÷ 12	22	22	010POM20
34	M25x1,5	11 ÷ 16	28	28	010POM25
50	M32x1,5	15 ÷ 21	35	35	010POM32

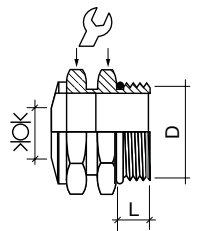

Ghiere ribassate / Flat rings nuts



gr.	D		S	
4	M16x1,5	19	3	010GM16
6	M20x1,5	24	3,5	010GM20
12	M25x1,5	30	3,5	010GM25
26	M32x1,5	36	4,5	010GM32

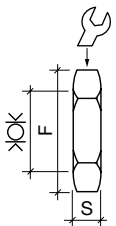

Nippli / Nipples



gr.	D	XOK	L	
8	M16x1,5	12	21	010NPM16
20	M20x1,5	15	24,5	010NPM20
18	M25x1,5	20	25	010NPM25
30	M32x1,5	26	32	010NPM32

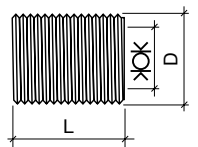

Bussole / Adaptors



gr.	D	XOK		L	
18	M16x1,5	12	22	12	010BM16
22	M20x1,5	15	26	14	010BM20
20	M25x1,5	21	30	14	010BM25
28	M32x1,5	28	40	15	010BM32

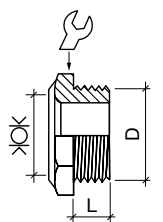

040/080



Valvola di ventilazione anticondensa Anti-condensate ventilation valve



La valvola anticondensa è la soluzione ideale per risolvere i problemi di compensazione di pressione e protezione dall'umidità che si possono creare nelle cassette pulsantiere poste in condizioni ambientali critiche. La particolare struttura a membrana permette la circolazione dell'aria ed impedisce l'entrata di liquidi all'interno della cassetta grazie anche alla guarnizione O-ring.

La valvola trova applicazioni ottimali in pannelli di controllo, telai di motori, cassette, pompe, luci sotterranee, luci spot, ecc.

The anti-condensate valve is the ideal solution to solve pressure compensation and humidity problems that could arise with push-button panels, enclosed in boxes and exposed to critical environmental conditions. Its special membrane configuration, along with the O-ring with which it is equipped, facilitate the circulation of air and prevent the entrance of liquids inside the box. This valve can be ideally used for control panels, motor frames, boxes, pumps, underground lighting systems, spot lights, etc.



Caratteristiche - Characteristics

Permeabile all'aria e resistente all'acqua in entrambe le direzioni.
Permeable to air and resistant on both sides.

Repellente all'olio: 010VV - 010VV400
Oleophobic: 010VV - 010VV400







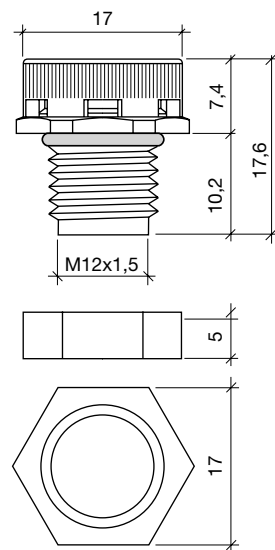

Superficie attiva delle membrane nel tappo di aerazione è di 0,5 cm²
Activated area of the membrane in the aeration cup is 0,5 cm²

Grado di protezione: IP67
Protection degree: IP67

Temperatura di lavoro: -40°C / + 105°C
Operating temperature: -40°C / +105°C

L'applicazione orizzontale non è consigliata
Horizontal application is not recommended



 gr.		permeabilità all'aria permeability to air	pressione ingresso acqua water inlet pressure		
	1,5		2 lt./min. $\Delta p = 70\text{mbar}$	max 0,1 bar / 60 s	010VV
	1,5		0,4lt./min. $\Delta p = 70\text{mbar}$	max 0,6 bar / 60s	010VV400
	1,5		1,7lt./min. $\Delta p = 70\text{mbar}$	max 0,3 bar / 60s	010VV1700
	0,7				010DM12